



Wiggins Bay Foundation Quarterly Newsletter

Neighbor Highlights – Mike Snyder’s 500 mile bike ride!

I spent the last week in July riding across Iowa with 30K other riders. Not a race, the ride is called RAGBRAI, (Register’s Annual Great Bicycle Ride Across Iowa). It is the oldest, largest, and longest multi-day bicycle touring event in the world. More than just a bike ride, it is an epic eight-day rolling festival of bicycles, music, food, camaraderie, and community. This year the ride was 500 miles and what may surprise many of you, Iowa is not flat. The total elevation for the week was 16,549 feet!

This was my 6th RAGBRAI and it is not something you do without getting in good bike shape. I spent several months in training, at our home in Colorado and on the streets of Naples. I did the ride with my lifelong friend John Hays. His wife Gwen provided us first-class support by driving their RV to the daily destination. RAGBRAI is a great opportunity to get in great shape, eat all you want and not gain weight! But the real reason I do RAGBRAI is the opportunity to talk to as many of the 30K riders as I can and learn their reasons to ride 500 miles across the corn fields of Iowa.



Mike and his wife Yazmin purchased in Bermuda Cove in 2001. Mike and Yaz enjoy the club and Mike is a tennis player. Both can be found in the fitness center and Yaz is a regular at water aerobics. After visiting the Snyder’s and Wiggins Bay, John and Gwen Hays, Mike’s RAGBRAI cohorts, will rent in Princeton Place this winter!

Nature Spotlight—Wiggins Bay Villas’ Pollinator Garden

There is a gem inside the walls of Wiggins Bay, the Wiggins Bay Villas Pollinator Garden. Located off the pool parking lot, the garden was designed by Leslie Landert of Landert Landscape Design with input from several Villa residents.



A pollinator garden attracts pollinating insects, small animals and birds. A Butterfly Garden strictly attracts butterflies. The Villas garden was designed with the intent of growing specific nectar and pollen producing plants. There are name tags which identify each plant.

The garden is filled with Southwest Florida native and Florida friendly plants. We have a Royal Poinciana tree and a Hong Kong Orchid tree. The trees serve as a canopy for our plants which range from the delicate Milkweed, Red and Purple Salvia and evergreen Jamaican Caper. A beautiful ground cover, the Sunshine Mimosa, with its light pink leaves is planted by the bench. A very impressive Prickly Pear cactus is also in the mix.

A Passion Flower vine climbs our trellis. It is host to the Gulf Fritillary butterfly and depending on the season, it is full of hungry caterpillars. While they are munching the vine looks very naked (defoliated) but it does come back with more foliage than ever.

The Garden needs bimonthly care which includes pruning, trimming back and mulching the area. Help is welcome. Come visit this garden, sit on the bench under the tree, think good thoughts and enjoy!

Learn more about Landert Landscape Design @ landertlandscapedesign.com

Getting To Know You--- Meet The Board



Sue McGill, President
Aruba @ Cove Towers
Resident



Gina Chilcoat, Treasurer
Villas Resident



Chip Kaczynski, Secretary
Princeton Place Resident



Bill Knab, Director
Villas Resident



Maureen (Mo) Shallcross, Director
The Colony Resident

Dining & Shopping – Ingredients for the perfect Happy Hour!



Many restaurants offer drink specials but Nancy Hudson (Princeton Place) shares the elements that attract her to a venue. (NR = Nancy Recommends)

What do you look for in the way of atmosphere? A relaxed, fun vibe that makes it easy to strike up conversations and make new friends. NR: Aqua

Where do you like to sit? I look for a nice bar with comfortable seating and it's a bonus if there is music! NR: Limoncello

Does service staff impact your restaurant choice? I'll always return to places with good bartenders/servers who remembers you, or even better, remember your drink preferences. NR: Pazzo!

Is there something particular you look for on the menu? A nice selection of bar bites and house wines. NR: Seasons 52

Nancy purchased in Building 3 Princeton Place in 2016 after seven years renting. In addition to checking out the local happy hour spots Nancy plays tennis, bridge, mah-jong and attends spinning class 3 days a week.

Property Updates --Bill Knab's Update on Tract 10

Tract 10 is the parcel of undeveloped land located at the corner of Wiggins pass road and Vanderbilt Dr.



It is part of the original Wiggins Bay PUD although the land itself is not owned by the Wiggins Bay Foundation. The Tract 10 property is owned by Trident-Dunes which is a separate entity from Kalea Bay and Kinsale Golf Course, but all are controlled by Soave Development. Tract 10 has been zoned as commercial since the original PUD in the 1980's, with numerous plans for development over the years. The County needs additional parking for boats and trailers to service the Cocohatchee boat launch across Vanderbilt Dr.. The previous proposal was to develop tract 10 with 100 boat trailer spaces for the boat launch. The proposal currently on the table is to divide the property, with about 1/2 remaining commercial (Parcel B) and the other 1/2 parking for boats/trailers (Parcel A).



All the developer is required to do is provide a site development plan and comply with current commercial building codes in order to build on the Parcel B portion of the Tract 10 that is not being donated to the county. The commercial building codes require a 6 foot security wall between a commercial property and a residential property, they also limit the height of a commercial building to 35 feet. Currently there is no site plan submitted and no permit applied for Tract 10, Trident Dunes has not disclosed their specific plans for the commercial building.

The golf course will be drained via a drainage easement across Tract10 and emptying into a wetland owned by Wiggins Bay Dock Owners Association, just west of Princeton Place building 300.

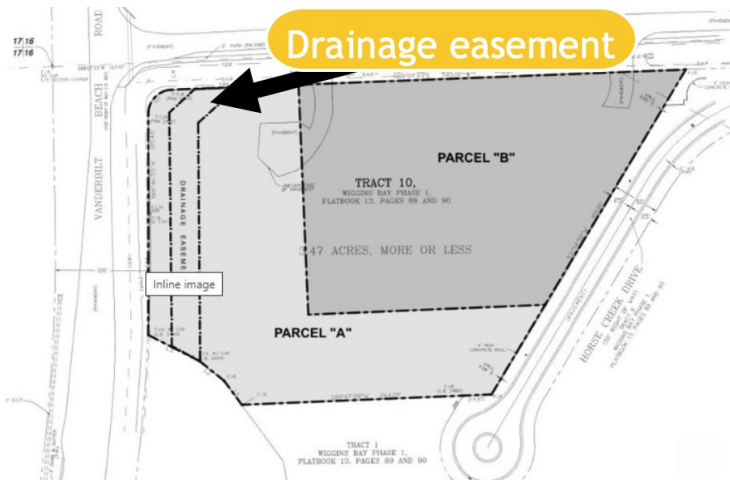

The Wiggins Bay Foundation Board and other community boards nearby are engaged to understand the impact on the community and influence these changes. We have plans to meet with our Commissioner Chris Hall in September to voice our concerns with the current proposal and obtain a better understanding of the developers plans. You may find more detailed information on the Wiggins Bay Foundation Website.

Around the Neighbor—Farewell to another victim of Ian

As Hurricane Idalia moved through the Gulf of Mexico the beautiful Ficus tree that graced our community was taken down. We will all miss its beauty.



Contributions

If you are interested in contributing an article or want to suggest a topic of interest to our residents, please reach our to Mo Shallcross at 864.477.0287 or shallcross3@gmail.com.